



**Food and Agriculture  
Organization of the  
United Nations**



**International Treaty  
on Plant Genetic Resources  
for Food and Agriculture**

**INTERNATIONAL TREATY ON PLANT GENETIC RESOURCES  
FOR FOOD AND AGRICULTURE**

**SIXTH MEETING OF THE AD HOC TECHNICAL EXPERTS GROUP  
ON FARMERS' RIGHTS**

**Rome, Italy, 23—26 June 2025**

**NOTE FOR PARTICIPANTS**

### **I. ACCESS TO FAO**

1. The FAO Headquarters Complex is located on Viale delle Terme di Caracalla, in front of the Circo Massimo. FAO can be reached by taxi, bus (No. 60, 75, 81, 118, 160, 271, 628), and metro line B (Circo Massimo stop).
2. To enter FAO premises, participants should use the provisional entrance for visitors on Viale Aventino 7 (please see map at the end of this document). Participants need to bring a valid identification document (passport or other type of official identification card with a photograph) with them. A FAO building pass will be granted, which must be worn at all times. Proceed to the internal desk to collect your meeting pass which identifies your status in the meeting. Access to FAO Headquarters is restricted to persons in possession of a valid building pass.
3. Lost Building Passes should be reported without delay to the FAO Security Office. For assistance or any request, please contact in FAO, extension 53145 or from outside FAO +39 06 570-53145.or by e-mail: [pgrfa-treaty@fao.org](mailto:pgrfa-treaty@fao.org)

### **II. INFORMATION ON VISAS**

4. Participants requiring visas must obtain these from the Italian Consulate or competent Diplomatic Mission in their country before leaving for Rome. Visa applications must be submitted well in advance of departure, as three weeks or more may be required for an Italian visa to be issued. Visas are the individual responsibility of participants. Please note that Italy is a signatory to the Schengen Treaty, which does not allow shortcuts to the established procedure, hence FAO cannot intervene in any way to hasten the process.

### **III. MEETING**

5. The meeting will start on Monday, 23 June at 10.00 in the Philippines Room, located on the second floor of building C (room C277/281). For a detailed timetable, please see the Provisional Agenda and Tentative Timetable at the following link <https://www.fao.org/plant-treaty/meetings/meetings-detail/en/c/1729970/>
6. The meeting will be conducted in Arabic, English, French and Spanish.
7. There will be two sessions per day - a morning session from 10.00 to 13.00 and an afternoon session from 14.30 to 17.30. Coffee and tea will be served outside the meeting room each morning from 09:30.
8. Should you need any assistance in relation to participation in this meeting from the International

Treaty Secretariat, please contact +39 5705 5430 or Ms. Natalie Nicora (+ 39 5705 4258) or e-mail [pgrfa-treaty@fao.org](mailto:pgrfa-treaty@fao.org)

9. A map of the FAO buildings and Meeting Rooms is available on the last page of this document.

#### IV. ACCOMMODATION AND DSA

10. The participation of developing country members to the Sixth meeting of the AHTEG-FR will be financially supported. Accommodation for funded participants has been booked at the Hotel Ripa (<https://www.hotelriparoma.com/en/>) and paid for by the Secretariat, and travel arrangements are finalized by the FAO Travel Agent. Self-supported participants are advised to check hotels in the Aventino area.

11. Daily Subsistence Allowance (DSA) is to be collected, if not delivered to relevant bank accounts, in Room D-202, from 09.00 to 11.00, Monday to Friday. You will have to show your passport in order to receive the allocated DSA.

#### V. FACILITIES AND ADDITIONAL SERVICES

12. **Banks:** You can carry out all banking operations within FAO: at Banca Intesa San Paolo (ground floor, Building B) open Monday to Friday from 08:35 to 16:35 hours, and Banca Popolare di Sondrio (ground floor, Building D) open from Monday to Friday from 08:30 to 16:00 hours. Cash dispensers (ATMs) are located at the entrance of the banks (ground floor, Buildings B and C) and post office (ground floor, Building B).

13. **Medical Services and Emergencies:** A medical unit is permanently on duty Monday through Friday, 8.30 to 17 hours, in Building B first floor, office 162, extension: 53577. For medical emergencies, dial 30 from all in-house telephones. For all other medical services, call ext. 53577 from in-house telephones (06 57053577) from outside FAO headquarters. For a serious emergency outside FAO, call 112.

14. **All entrances** at the FAO Headquarters Complex are accessible to people using wheelchairs. A lift is specially provided in Building A, and a ramp is provided in Building D. All lifts throughout the FAO Headquarters Complex have wheelchair access.

#### VI. CATERING FACILITIES

15. Within the FAO buildings there are three coffee shops, a cafeteria, and a restaurant.

- **Uzbekistan Lounge:** Coffee shop located on the 8th floor of Building C. They serve snacks and sandwiches all day. Hours from 08.00–17.00.
- **Fountain bar:** Coffee shop located on the 8th floor of Building B. They offer an assortment of coffee, teas, pastries, sandwiches, yoghurts and beverages. Hours: 08.00-17.00.
- **Restaurant:** Located on the 8th floor of Building C. They offer a complete ‘menu of the day’ or ‘à la carte’ menu. Hours 12–14. Reservation required (extensions: 54268 or 56823).
- **Delegates Bar:** Ground floor building A from 8:00 to 17:00. They serve an assortment of coffees, teas, pastries, beverages, ice cream, sandwiches and fresh salads, poké.
- **Bar D:** Ground floor building D from 07.30 to 17.00. They offer an assortment of sandwiches, pizza, fresh salads, hot main dishes, beverages, yoghurts, ice creams, fruits and coffee.
- **Food court:** Self-service restaurant located on the 8th floor of Building B. Self-service option offering a variety of organic and international food choices. Hours 11.45–14.30.
- **Restaurant buffet:** Located on the 8th floor of Building C. They offer an open buffet food choice. Hours 12.00–14.30. Reservation required (extensions: 54268 or 56823).

16. ATM and credit card are accepted in all locations.

17. Several vending machines with coffee and snacks are also located on the premises.

18. Other restaurant facilities are located on Viale Aventino close to FAO Headquarters.

## VII. ELECTRICITY

19. In Italy, the current is 220 volts; plug type is European standard. The sockets are 3 round pins in a row.

## VIII. EMERGENCY TELEPHONE NUMBERS IN ROME

20. The following numbers may be useful in case of emergency outside FAO

- 112 = National emergency number (police, ambulance, firefighters)
- 118 = Ambulance
- 115 = Fire department

## IX. INTERNET ACCESS

21. The meeting room, as well as many other areas in FAO, has Wi-Fi access. To connect:

- a. Turn on your laptop or wireless device while in an area providing Wi-Fi services
- b. If your device has the Wi-Fi adapter enabled, a message should appear that says the Wi-Fi services "FAO-Guest" has been detected.
- c. Click connect and log in with ID: visitor and Password: FAOunited2024.

## X. PUBLIC TRANSPORTATION

22. Tickets for public transport should be purchased in advance and are available from self-service ticket machines in the Metro stations, at ticket offices in underground stations, tobacco shops (Tabaccheria) and newspaper kiosks. They can also be purchased online through several mobile applications. In the metro, you can also pay with your swipe card.

23. Tickets cost €1,5 for a standard ticket valid for one metro ride and unlimited bus/tram travel within the ticket validation time of 100 minutes; €7.00 for a 24-hour ticket; €12.50 for a 48-hour ticket; €18.00 for a 72-hour ticket; €24.00 for a weekly ticket. Printed tickets need to be validated upon entering bus, tram or metro and the online tickets activated.

24. There are three underground metro lines in Rome: Line A, Line B and Line C. The stops are marked by a red and white "M" sign. Termini Station is the only hub of the Rome Metro where lines A and B intersect. The Metro stop for FAO is "Circo Massimo" (Line B). For a map of local train and subway lines see [Metro di Roma](#).

25. For further information on the routes and schedules of public transportation, please consult ATAC's website <http://www.atac.roma.it>

## XI. TRANSPORT TO AND FROM THE AIRPORT

26. Rome has two major airports: Fiumicino/Leonardo da Vinci (FCO), and Ciampino (CIA). Fiumicino is the main airport, and is served by taxis, trains, and shuttle services. The fixed taxi rates are €55 from Fiumicino to the centre of Rome, and €40 from Ciampino to the centre of Rome. The Leonardo express train from Fiumicino airport to the Termini train station (€14) departs from the airport every half hour between 06:35 and 23:35. The local trains (€8) stop at Ostiense station (end station is Fara Sabina), a 15-minute walk from FAO headquarters and depart approximately every 15 minutes. Tickets may be purchased online or from vending machines or at the Tabacchi (newspaper stand/kiosk) at the train station in the airport. Remember to validate tickets before boarding the train.

## **XII. SECURITY**

27. While Rome is generally a safe city, theft can be a problem, in particular on public transportation and crowded streets. Participants are reminded to carry their valuables safely, and to keep photocopies of identification documents in a safe place in case they need to have them replaced. Lost building passes should be reported without delay to the FAO Office of Security. The FAO Office of Security operates from 07.30 a.m. to 17.30 from Room B062 (extension 55159); after 17:30 contact the Security Guards in Building A (extension 53145, 06-5705-3145 from outside FAO).

## **XIII. TAXIS**

28. Participants are advised to use only licensed taxis with meters. Taxis from the City of Rome are white and can be recognized by the sign "TAXI" on the car top and must have an identifying license number on the doors, the back and inside the car. Surcharge fares are applied for baggage, night runs and on Sundays and holidays.

## **XIV. TRAVEL AGENCY**

29. You may call upon Carlson Wagonlit Travel agency located on the ground floor of FAO (D074). The Agency is open Monday-Friday between 9.00 to 12.45 and 14 to 17. A small commission may be applied to travel operations. Emergency line out of office hours +39 06 82075812 and via e-mail at [faotravel.it@contactcwt.com](mailto:faotravel.it@contactcwt.com).

## **XV. BOOKSHOP**

30. On the ground floor of Building B, the Food for Thought Bookshop offers a selection of English, French and Spanish language books, gift stationery, and writing paper, gift wrapping paper, greeting cards and guidebooks. Open from 8:00 to 17:00. For more information call extension 53127.

## **XVI. FAO SHOP**

31. Ground floor of building B, the FAO Shop offers a selection of branded merchandise and FAO publications. Open on Tuesdays, Wednesdays and Thursdays from 10:30 to 16:30. For more information write to [FAO-Shop@fao.org](mailto:FAO-Shop@fao.org). Access the catalogue here.

## **XVII. LOST AND FOUND**

32. If you have lost or found something, please contact the Entrance Reception on the ground floor, Building A, or the Guard Service, extension 54427.

## **XVIII. MEDITATION ROOM**

33. A meditation area is available in Building A, second floor, room A 250ter.

## **XIX. CONTACTS**

34. For assistance, you can contact the ITPGRFA Secretariat:

Inma Roda Martín: [Inma.RodaMartin@fao.org](mailto:Inma.RodaMartin@fao.org)

Natalie Nicora: [Natalie.Nicora@fao.org](mailto:Natalie.Nicora@fao.org)

Fabrice Mongin: [Fabrice.Mongin@fao.org](mailto:Fabrice.Mongin@fao.org)

# FAO FLOOR PLAN

## FAO SERVICES

- |  |                                   |  |                 |
|--|-----------------------------------|--|-----------------|
|  | ENTRANCE / EXIT                   |  | MEETING ROOMS   |
|  | RECEPTION AREA                    |  | ATRIUM          |
|  | INFORMATION DESK                  |  | LIBRARY         |
|  | D. LUBIN LIBRARY                  |  | BAR/CAFETERIA   |
|  | BANK                              |  | FACILITIES      |
|  | POST OFFICE                       |  | HEALTH SERVICES |
|  | NEWSTAND / BOOKSHOP               |  | EMERGENCY EXIT  |
|  | LACTATION ROOM                    |  | ASSEMBLY POINT  |
|  | INSURANCE                         |  | TOILETS         |
|  | TRAVEL AGENCY                     |  | LIFTS           |
|  | BAR                               |  |                 |
|  | CAFETERIA / RESTAURANT AND BUFFET |  |                 |

## FAO MEETING ROOMS

<b>3 FLOOR</b>		
	21 PLENARY	A335 int
	22 CARIBBEAN	A335 bis
	23 THAILAND	A382 bis
	24 SUDAN	A381
	25 CANADA	A357
	26 INDIA	A327
	27 QUEEN JULIANA	B324
<b>2 FLOOR</b>		
	10 IRAQ	A235
	11 MALAYSIA	B227
	12 CUBA	B224
	13 ETHIOPIA	C285
	14 NIGERIA	C215
	15 PHILIPPINE	C277
	16 GERMAN	C269
	17 AUSTRALIA	C237
	18 LEBANON	D209
	19 MEXICO	D211
	20 KING FAISAL	D263
<b>1 FLOOR</b>		
	6 RED	A121 int
	7 GREEN	A121 ter
	8 PAKISTAN	A127
	9 IRAN	B116 bis
<b>0 FLOOR</b>		
	1 U.E.M.O.A.	A018
	2 GABON	A025
	3 SHEIKH ZAYED	Atrium
	4 SLOVAK	B013
	5 FLAG	B018

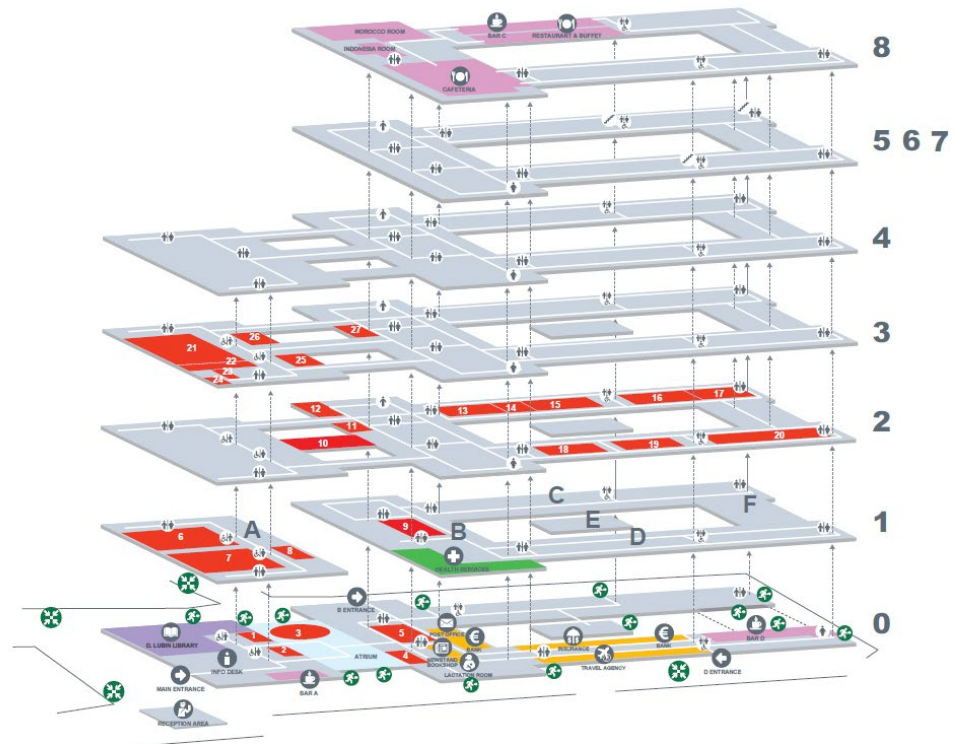

### PROVISIONAL ENTRANCE TO FAO PREMISES

